

EXISTING CONDITIONS SITE PLAN
SCALE: 1"=30'

1438 SOUTH BROWNELL ROAD WILLISTON, VERMONT 05495 PHONE: (802) 862-7598 FAX: (802) 862-7598	
DRAFT	
DRAFT PRELIMINARY PROGRESS PRINT NOT FOR CONSTRUCTION 1/17/2021	
EXISTING CONDITIONS SITE PLAN	PROJECT: STONEY HILL PROPERTIES CLIENT: STONEY HILL PROPERTIES LLC, BRISTOL, VERMONT
DESIGNED: JLS DRAWN: JJB CHECKED: JLS	PLOT DATE: 1/17/2021 SCALE: 1" = 30' DATE: JAN. 2021
PROJECT NO. 30-009	
DRAWING NO. 03	
REV. DATE DESCRIPTION BY	REV. DATE DESCRIPTION BY

FILE: S:\PROJECT FILES\30-009 TOWN OF BRISTOL - STONEY HILL PROPERTIES INFRASTRUCTURE DRAWINGS\SSR\BASE WORKING 17.021.DWG

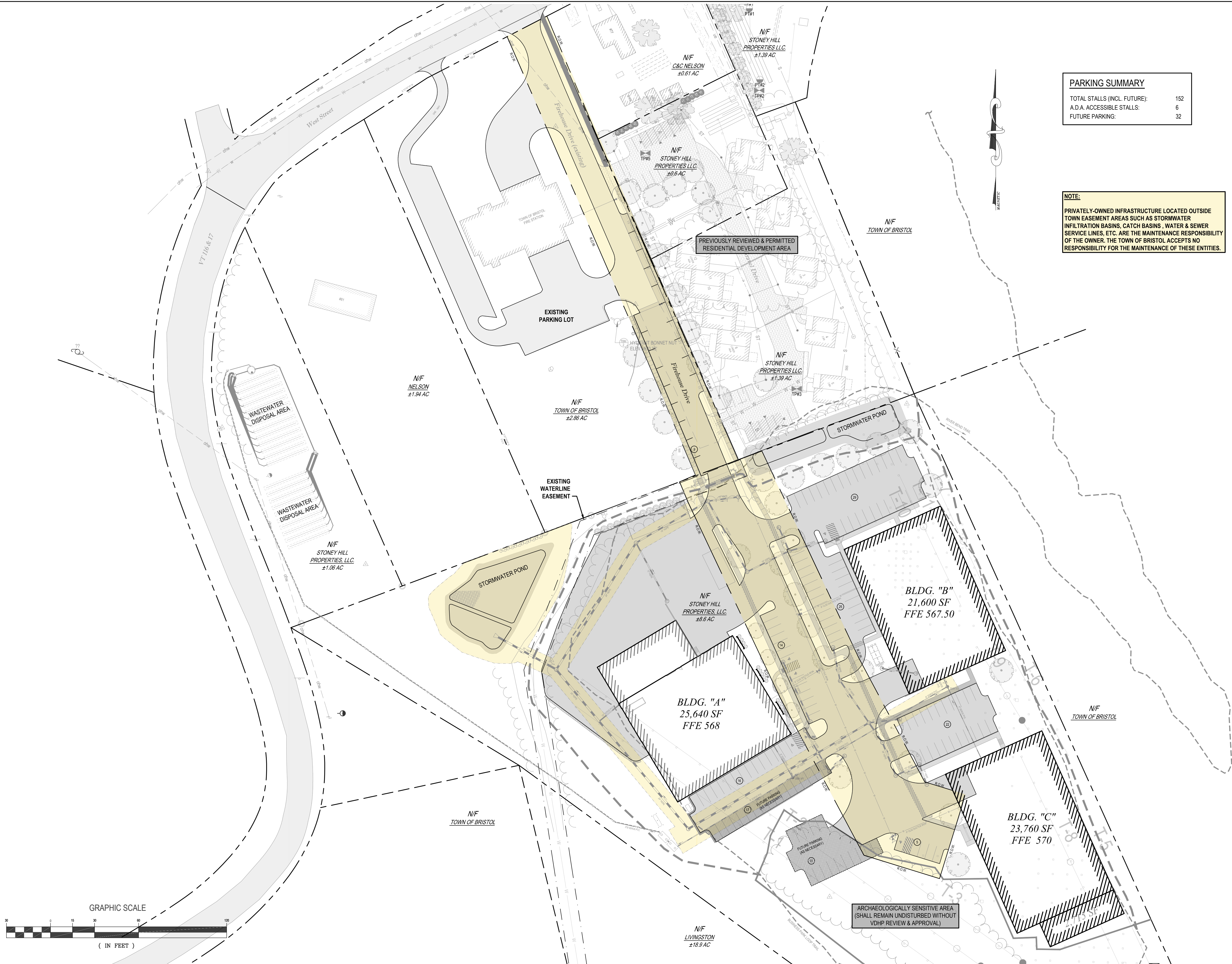

PARKING SUMMARY	
TOTAL STALLS (INCL. FUTURE):	152
A.D.A. ACCESSIBLE STALLS:	6
FUTURE PARKING:	32

NOTE:
 PRIVATELY-OWNED INFRASTRUCTURE LOCATED OUTSIDE TOWN EASEMENT AREAS SUCH AS STORMWATER INFILTRATION BASINS, CATCH BASINS, WATER & SEWER SERVICE LINES, ETC. ARE THE MAINTENANCE RESPONSIBILITY OF THE OWNER. THE TOWN OF BRISTOL ACCEPTS NO RESPONSIBILITY FOR THE MAINTENANCE OF THESE ENTITIES.

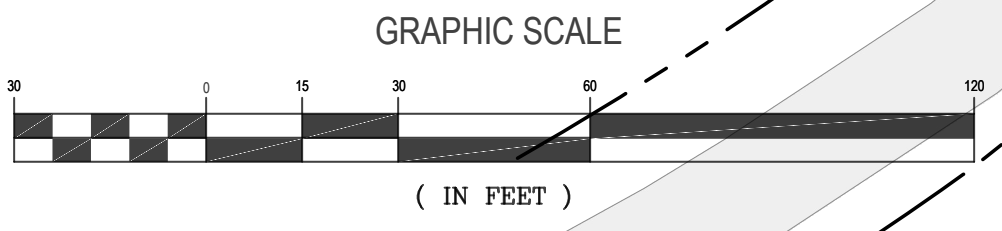

SITE PLAN
 SCALE: 1"=50'

REV.	DATE	DESCRIPTION	BY

1438 SOUTH BROWNELL ROAD
 WILLISTON, VERMONT 05495
 PHONE: (802) 862-7598
 FAX: (802) 862-7599

CIVIL
 WATER
 WASTEWATER

DRAFT

DRAFT
 PRELIMINARY PROGRESS PRINT
 NOT FOR CONSTRUCTION
 1/17/2021

SITE PLAN W/ RESIDENTIAL DEVELOPMENT (FOR REVIEW & PERMITTING)		PROJECT STONEY HILL PROPERTIES STONEY HILL PROPERTIES LLC, BRISTOL, VERMONT
DESIGNED JLS	PLLOT DATE 1/17/2021	CLIENT STONEY HILL PROPERTIES LLC, BRISTOL, VERMONT
DRAWN JJB	SCALE 1" = 50'	PROJECT NO. 30-009
CHECKED JLS	DATE JAN. 2021	DRAWING NO. 04

FILE: S:\04 PROJECT FILES\30-009 TOWN OF BRISTOL STONEY HILL PROPERTIES INFRASTRUCTURE DRAWINGS\30-009-04-01.DWG

NOTE:
WASTEWATER DISTRIBUTION DESIGN SUBJECT TO CHANGES PER REVIEW OF THE VERMONT AGENCY OF NATURAL RESOURCES REGIONAL OFFICES PROGRAM, WASTEWATER MANAGEMENT DIVISION.

- KEY**
- TOWN RIGHT-OF-WAY & EASEMENT AREAS
 - EXISTING PAVED AREAS
 - PROPOSED PAVED AREAS

SEWER MANHOLE DATA TABLE									
ID#	RM ELEV.	REV. DATE	DIAM. OUT	REV. IN #1	DIAM. IN #1	REV. IN #2	DIAM. IN #2	REV. IN #3	DIAM. IN #3
SMH#2	556.8	556.0	6"Ø PVC	556.8	6"Ø PVC	556.8	6"Ø PVC	556.8	6"Ø PVC
SMH#1	556.0	557.0	6"Ø PVC	557.0	6"Ø PVC	558.0	6"Ø PVC	558.0	6"Ø PVC
UMP STATION	552.5	558.0	24"Ø PVC	558.0	6"Ø PVC	-	-	-	-

WASTEWATER SUMMARY	
TOTAL GAL./DAY CAPACITY:	4,500
DOMESTIC WASTEWATER GENERATED PER EMPLOYEE (GPD):	15
MAX. NO. OF EMPLOYEES SERVED:	306

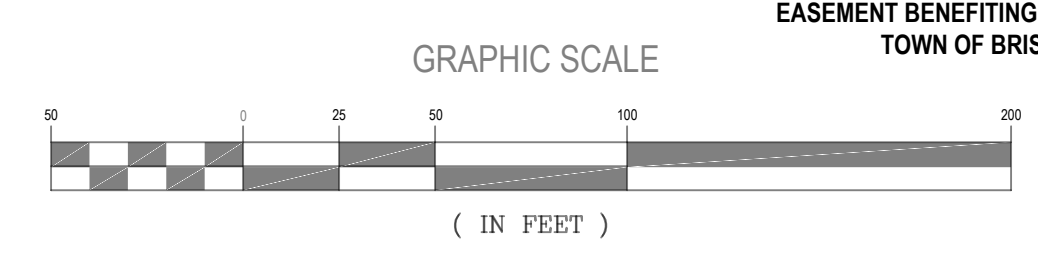
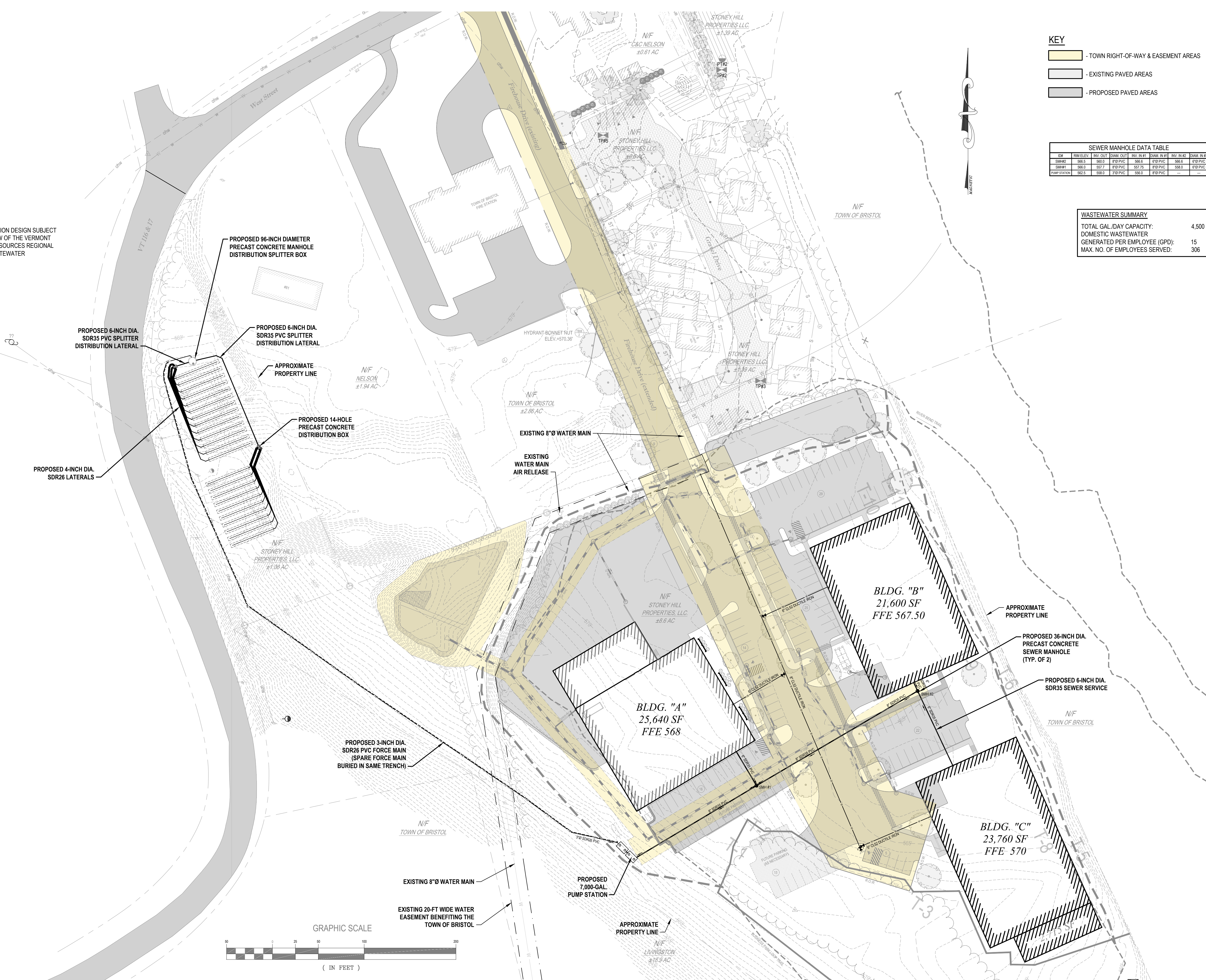

WATER & WASTEWATER SITE PLAN
SCALE: 1"=30'

REV.	DATE	DESCRIPTION	BY

1438 SOUTH BROWNELL ROAD
WILLISTON, VERMONT 05498
PHONE: (802) 862-7598
FAX: (802) 862-7599

GREEN MOUNTAIN ENGINEERING
CIVIL WATER WASTEWATER

DRAFT

DRAFT
PRELIMINARY PROGRESS PRINT
NOT FOR CONSTRUCTION
1/17/2021

DRAWING TITLE		PROJECT		CLIENT	
WATER & WASTEWATER SITE PLAN		STONEY HILL PROPERTIES		STONEY HILL PROPERTIES LLC, BRISTOL, VERMONT	
DESIGNED	JLS	PLLOT DATE	1/17/2021		
DRAWN	JJB	SCALE	1" = 50'		
CHECKED	JLS	DATE	JAN. 2021		
PROJECT NO.					
30-009					
DRAWING NO.					
1					

FILE: S:\09 PROJECT FILES\30-009 TOWN OF BRISTOL, STONEY HILL PROPERTIES MANUFACTURE DRAWINGS\30-009-017-2021.DWG

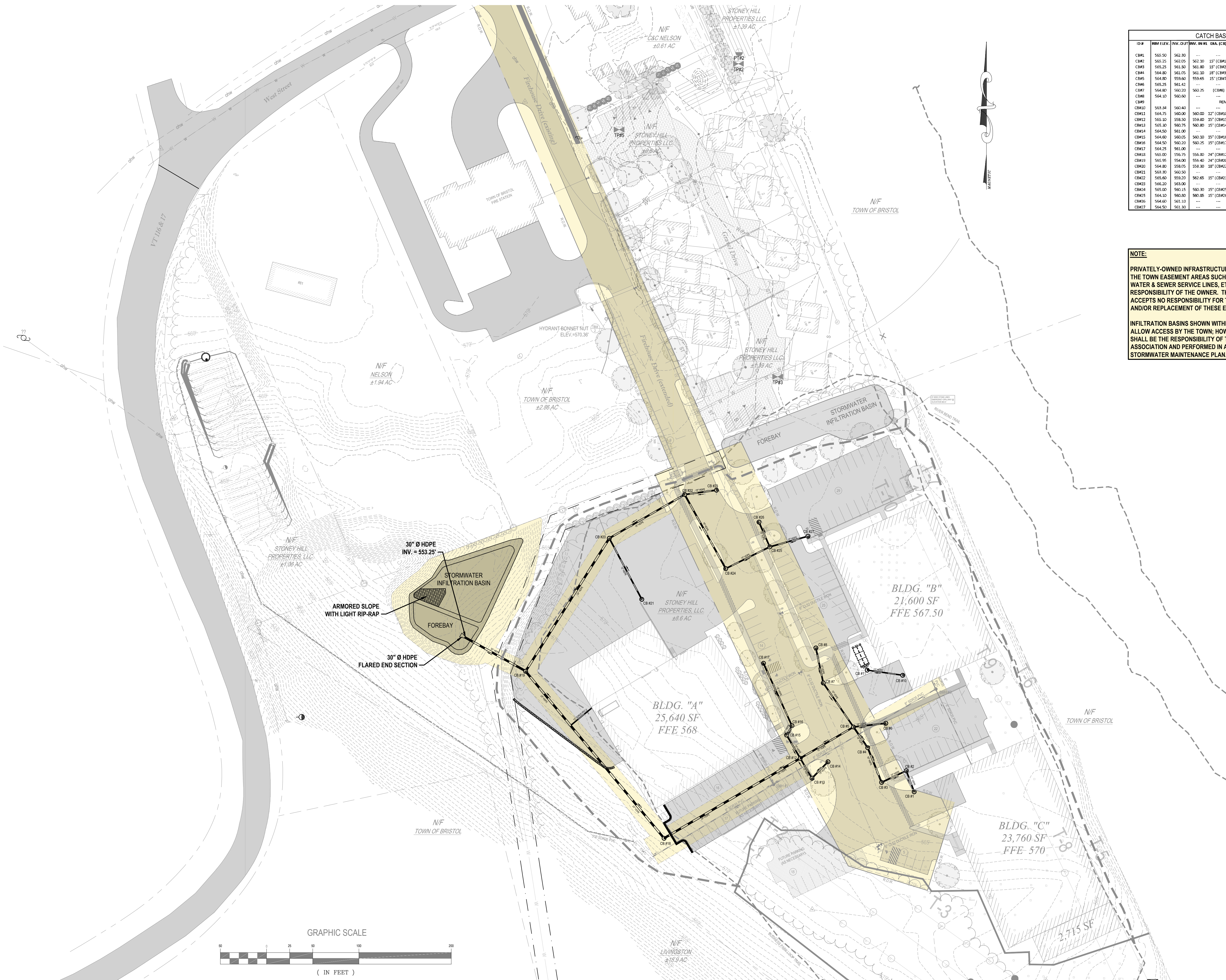

ID #	INV. ELEV.	INV. DIA.	INV. IN. #1	INV. IN. #2	INV. IN. #3	DIAM. (CB)	DIAM. (CS)	SUMP
CB#1	565.50	36.00	1'
CB#2	565.25	36.00	562.30 15" (CB#1)	1'
CB#3	565.25	36.00	562.30 15" (CB#1)	1'
CB#4	564.80	36.00	561.80 15" (CB#3)	1'
CB#5	564.80	36.00	559.65 15" (CB#7)	561.10 15" (CB#6)	560.80 15" (CB#4)	1'
CB#6	565.25	36.00	1'
CB#7	564.80	36.00	560.75 (CB#6)	1'
CB#8	564.10	36.00	1'
CB#9	1'
CB#10	563.84	36.00	1'
CB#11	564.75	36.00	560.00 12" (CB#10)	9'
CB#12	565.10	36.00	559.80 15" (CB#11)	558.95 15" (CB#5)	560.50 15" (CB#12)	1'
CB#13	565.30	36.00	560.80 15" (CB#4)	1'
CB#14	564.50	36.00	1'
CB#15	564.60	36.00	560.30 15" (CB#16)	1'
CB#16	564.50	36.00	560.25 15" (CB#17)	1'
CB#17	564.25	36.00	1'
CB#18	565.00	36.00	556.80 24" (CB#12)	1'
CB#19	565.95	36.00	554.40 24" (CB#18)	1'
CB#20	564.80	36.00	558.30 15" (CB#21)	559.75 12" (CB#22)	1'
CB#21	564.80	36.00	1'
CB#22	565.60	36.00	562.65 15" (CB#23)	559.25 18" (CB#24)	1'
CB#23	566.20	36.00	1'
CB#24	565.00	36.00	560.30 15" (CB#25)	1'
CB#25	564.10	36.00	560.85 15" (CB#26)	560.85 15" (CB#27)	1'
CB#26	564.60	36.00	1'
CB#27	564.50	36.00	1'

NOTE:
 PRIVATELY-OWNED INFRASTRUCTURE EXTENDING BEYOND THE TOWN EASEMENT AREAS SUCH AS STORM DRAIN PIPES, WATER & SEWER SERVICE LINES, ETC. ARE THE MAINTENANCE RESPONSIBILITY OF THE OWNER. THE TOWN OF BRISTOL ACCEPTS NO RESPONSIBILITY FOR THE MAINTENANCE AND/OR REPLACEMENT OF THESE ENTITIES.
 INFILTRATION BASINS SHOWN WITHIN THE TOWN R.O.W. ALLOW ACCESS BY THE TOWN; HOWEVER, MAINTENANCE SHALL BE THE RESPONSIBILITY OF THE OWNERS ASSOCIATION AND PERFORMED IN ACCORDANCE WITH THE STORMWATER MAINTENANCE PLAN.

1438 SOUTH BROWNELL ROAD WILLISTON, VERMONT 05495 PHONE: (802) 862-7598 FAX: (802) 862-7598	 CIVIL WATER WASTEWATER DRAFT
DRAFT PRELIMINARY PROGRESS PRINT NOT FOR CONSTRUCTION 1/17/2021	
STORMWATER INFRASTRUCTURE SITE PLAN PROJECT: STONEY HILL PROPERTIES CLIENT: STONEY HILL PROPERTIES LLC, BRISTOL, VERMONT	PROJECT NO. 30-009 DRAWING NO. 06

STORMWATER INFRASTRUCTURE SITE PLAN
 SCALE: 1"=50'

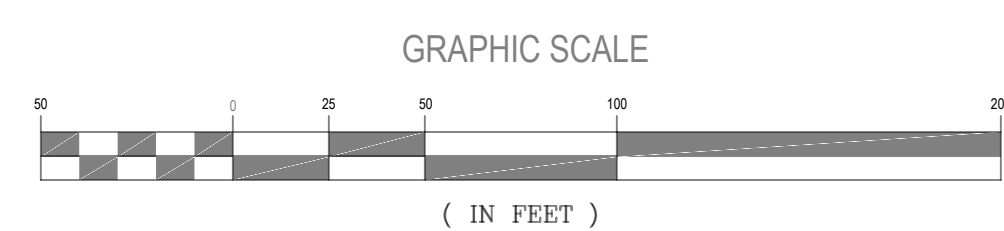
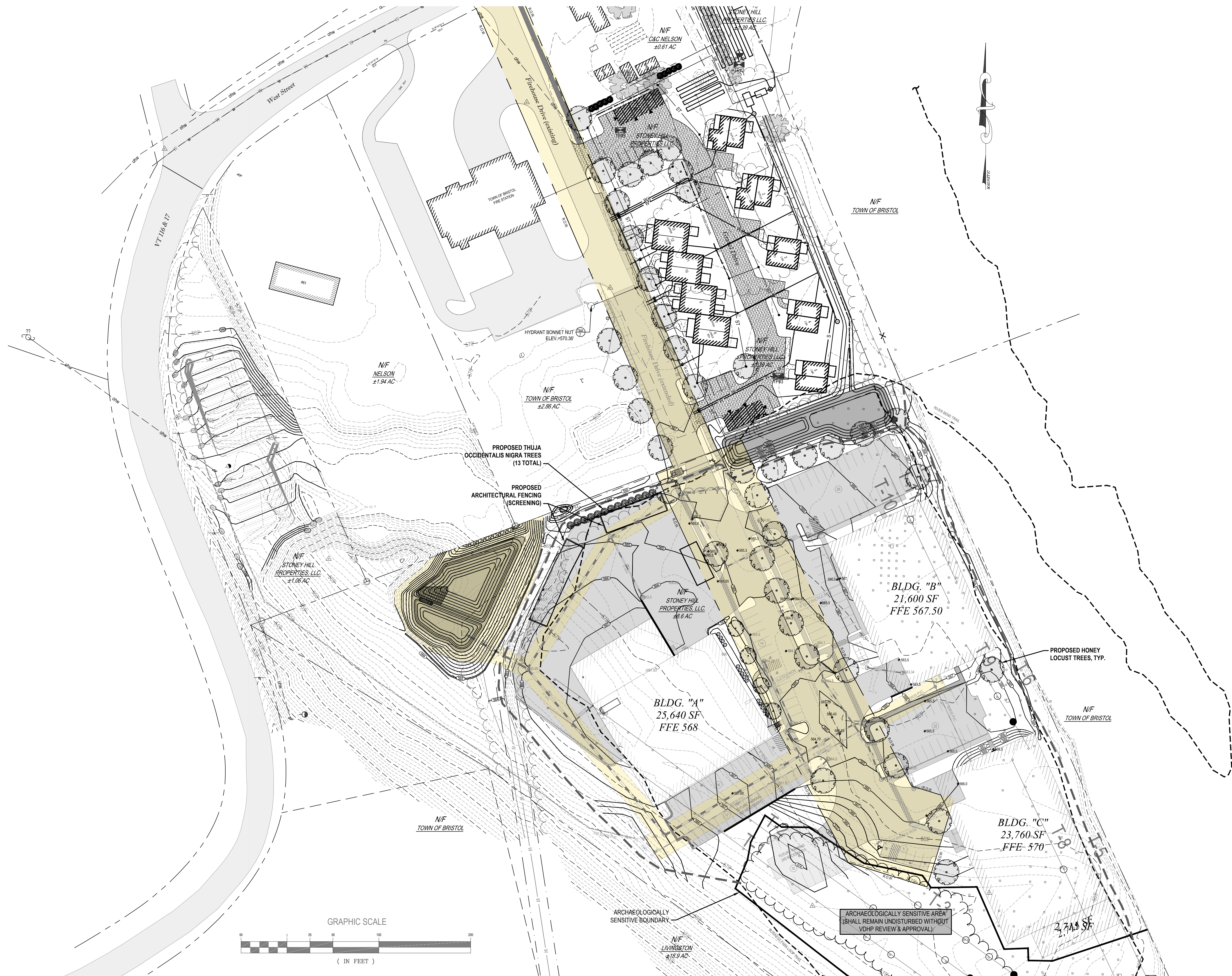

GRADING & LANDSCAPING SITE PLAN
SCALE: 1"=50'

1438 SOUTH BROWNELL ROAD WILLISTON, VERMONT 05495 PHONE: (802) 862-7598 FAX: (802) 862-7598			
 GREEN MOUNTAIN ENGINEERING CIVIL WATER WASTEWATER			
DRAFT			
DRAFT PRELIMINARY PROGRESS PRINT NOT FOR CONSTRUCTION 1/17/2021			
DRAWING TITLE PROJECT CLIENT	PROJECT STONEY HILL PROPERTIES STONEY HILL PROPERTIES LLC BRISTOL, VERMONT		
DESIGNED DRAWN CHECKED JLS JJB JLS	PLOT DATE SCALE DATE 1/17/2021 1" = 50' JAN. 2021		
PROJECT NO. 30-009			
DRAWING NO. 07			
REV.	DATE	DESCRIPTION	BY